

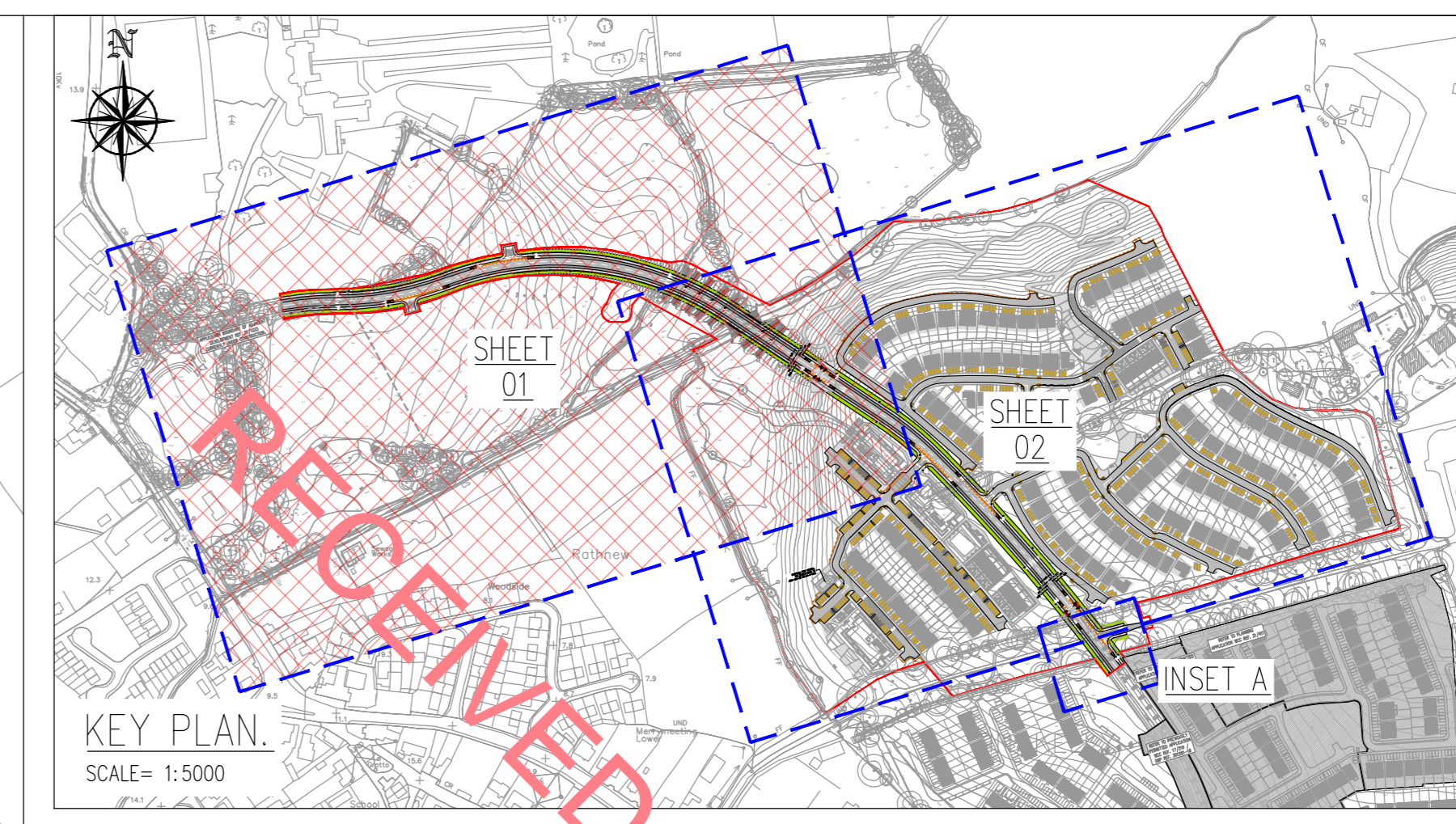

PROPOSED GENERAL ARRANGEMENT
SCALE: 1:500

APPLICATION BOUNDARY OF ADJACENT
DEVELOPMENT REF. 21/1333
CURRENTLY UNDER CONSTRUCTION.



LEGEND:

- PROPOSED SITE BOUNDARY
- PROPOSED CARRIAGEWAY
- PROPOSED CYCLETRACK ON-ROAD
- PROPOSED BRIDGE/OULVERT
- PROPOSED FOOTPATH
- PROPOSED GRASS VERGE
- PROPOSED PARKING SPACES
- PROPOSED RAISED TABLE
- PROPOSED TACTILE PAVING BUFF COLOURED (UNCONTROLLED CROSSING)
- PROPOSED TACTILE PAVING RED COLOURED (CONTROLLED CROSSING)
- PROPOSED STEEL CRASH BARRIER
- PROPOSED TIMBER CRASH BARRIER
- BOUNDARY OF ADJACENT DEVELOPMENT REF. 21/1333

DRAWINGS REFERENCES:

- REFER TO DRAWING A034-CSC-ZZ-XX-DR-C-0004 FOR WATERMAIN LAYOUT.
- REFER TO DRAWING A034-CSC-ZZ-XX-DR-C-0005 & 0006 FOR DRAINAGE LAYOUT.
- REFER TO DRAWING A034-CSC-ZZ-XX-DR-C-0017 FOR TYPICAL CROSS SECTIONS.
- REFER TO DRAWING A034-CSC-ZZ-XX-DR-C-0020 & 0021 FOR ROAD MARKINGS AND TRAFFIC SIGNS LAYOUT.
- REFER TO DRAWING A034-CSC-ZZ-XX-DR-C-0026-0033 FOR ROAD PLAN AND PROFILES.

PLANNING DRAWING.
NOT FOR CONSTRUCTION.
ALL LEVELS GIVEN ARE
RELATIVE TO ORDNANCE DATUM.
THIS DRAWING HAS BEEN ISSUED FOR INFORMATION
PURPOSES ONLY AND MUST NOT BE USED
FOR CONSTRUCTION UNDER ANY CIRCUMSTANCES

NOTES

- For setting out refer to Architect's drawings.
- This drawing to be read in conjunction with all other Architectural and Engineering drawings and all other relevant drawings and Specifications.
- DO NOT SCALE THIS DRAWING. Use figures dimensions only.
- No part of this document may be reproduced or transmitted in any form or stored in any retrieval system of any nature without the written permission of copyright holder except as agreed.
- Ordnance Survey Ireland Licence Number EN 0074023

Rev. No.	Date	REVISION NOTE	Drn. By	Chk. By
P1	12.12.2022	ISSUED FOR PLANNING	SC	NB
P2	16.04.2023	ISSUED FOR PLANNING	SC	NB
P3	20.04.2023	RED LINE BOUNDARY UPDATED	SC	NB
P4	07.07.2023	ISSUED FOR COORDINATION	SC	NB
P5	11.07.2023	LAYOUT UPDATES	SC	NB
P6	09.08.2023	ISSUED FOR PLANNING	SC	NB

Client	Keldrum Limited
Project	Large-scale Residential Development at Tinakilly, Wicklow
Title	Proposed General Arrangement Sheet 1 of 2
Dep. No.	A034-CSC-ZZ-XX-DR-C-0002
Date	09/08/2023
Scale	1:500 @ A0
Revision	P6

CS Consulting Group
DUBLIN | LONDON | LIMERICK

Head Office
19-21 Dame Street, Dublin 2.
T: +353 (0)1 4545063
E: info@csconsulting.ie
W: www.csconsulting.ie

Quality ISO 9001:2015
Environment ISO 14001:2004
Health & Safety OHSAS 18001:2007